

EC35 Removal Instructions

Please Note: The EC35 is designed for a one-time installation.

Step 1:

To remove the EC35: unplug the cable and remove the collet ring to free the rotation of the encoder module.

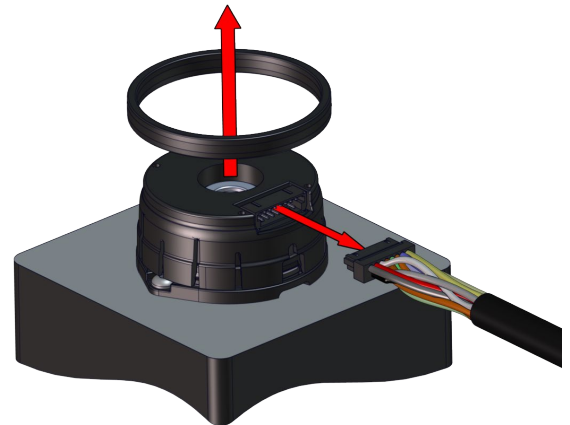

Step 2:

Rotate the encoder module until the screw access is aligned with one of the mounting screws. Remove the screw. Rotate the module to align the access with the remaining screw and remove.

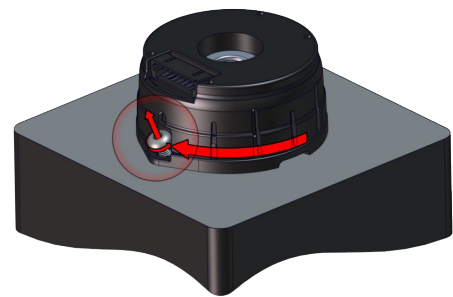

Step 3:

Using two flat head screwdrivers apply pressure to the underside of each pry point, located 180° opposed at the bottom of the mounting plate, and remove the encoder from the motor.

